



PANINI

ENGLISH 

ADVANCED
CONTROL



STEAM BOILER FOR THE
ECOVAP
EUROPEAN ENVIRONMENT

CHARACTERISTICS

- Respects European environmental directives
- Reduces up to 80% the production of nitrogen oxides NO_x
- Large furnace for increased radiation, low thermal gradient, and uniform smoke flow
- Large evaporation chamber
- Control panel with LCD display for Alarms:
 - Excess water hardness
 - High stack temperature
 - High pressure
 - Low water level
- Controls the following optional accessories:
 - O₂, CO₂
 - Constant yield
 - Constant water level control system
 - Automatic blowdown and Salinity control
 - Steam, water and gas flow meter
- Working pressure of 12, 15 or 18 bar

OPTIONAL ACCESSORIES

- Heat-recovery system
- Probes for O₂, CO₂ and yield recording
- Carbon monoxide analyzer
- Continuous water level control kit
- Automatic blowdown kit
- Automatic Salinity control kit
- Double pump kit for quick substitution
- Flow meter
- Personal computer interface for supervision

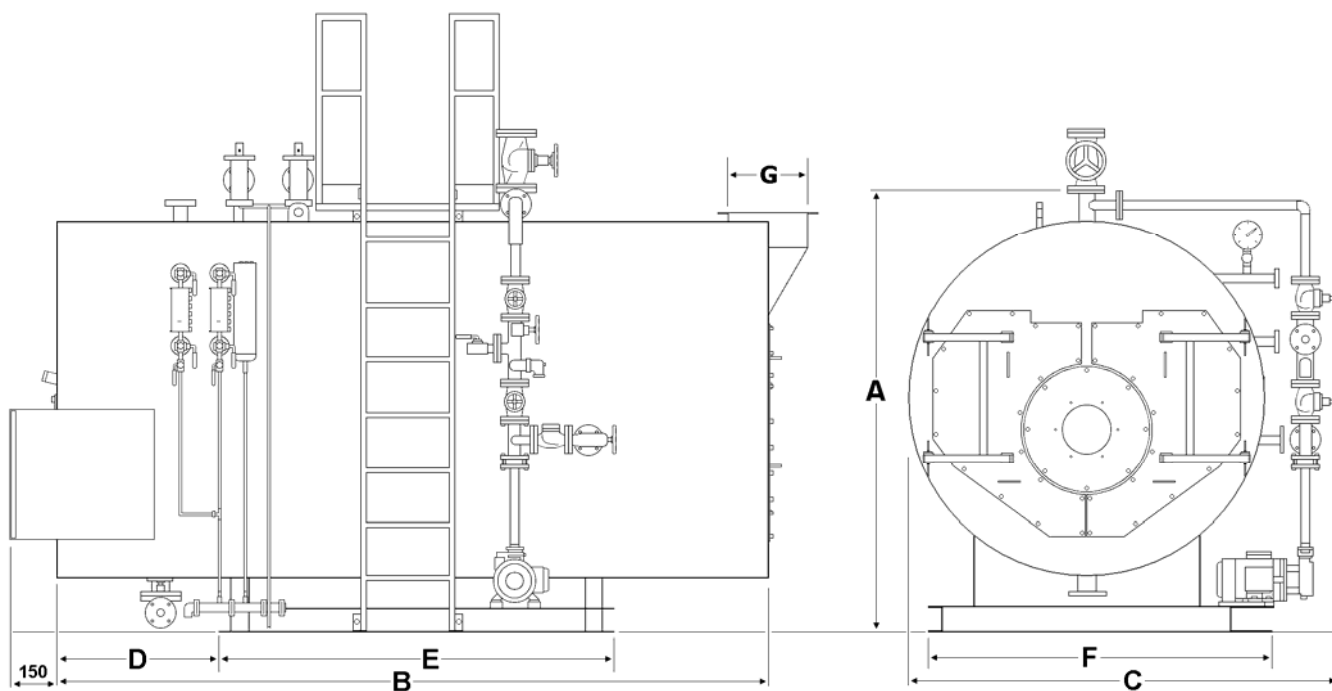

MODEL	STEAM Kg/h	POWER ¹		DIMENSIONS mm				CAPACITY liters		WEIGHT Kg
		KCal/h	Kw	A	B	C	D	TOTAL	WORKING	
Ecovap 4	4.000	2.400.000	2.790	2350	4550	2400	400	8.610	7.850	9.900
Ecovap 5	5.000	3.000.000	3.488	2500	4870	2900	500	9.700	7.850	11.760
Ecovap 6	6.000	3.600.000	4.186	2800	4870	3100	630	11.600	10.130	23.000
Ecovap 8	8.000	4.800.000	5.581	2800	6000	3100	630	15.750	12.500	24.200
Ecovap 10	10.000	6.000.000	6.976	3100	6200	3250	800	18.000	16.000	27.200
Ecovap 12	12.000	7.500.000	8.720	3100	6700	3250	800	22.000	18.000	29.500
Ecovap 15	15.000	9.000.000	10.465	3400	6700	3520	800	24.000	19.000	32.000
Ecovap 20	20.000	12.000.000	13.953	3850	7400	3520	1000	30.000	28.000	40.000

1) The declared power is calculated based on a standard feed water temperature of 90°C.

Note: The data indicated in the table are subject to change.